

Application Note

Integrating a kmd3 and DX Series Products

Overview

When extending a dealing service from a remote Dealing 3000 keystation to a kmd3 there are a number of important points to remember:

- The DXR2 must be switched to “Normal” mode, i.e DIP switch 8 must be turned OFF.
- When connecting the DXK2 / C2 rack cards to the Dealing 3000 keystation it is important that Serial 1 from the DXK2 / C2 is plugged into COM2 of the keystation and Serial 2 into COM1 (See Figure 2).

Connection Diagram

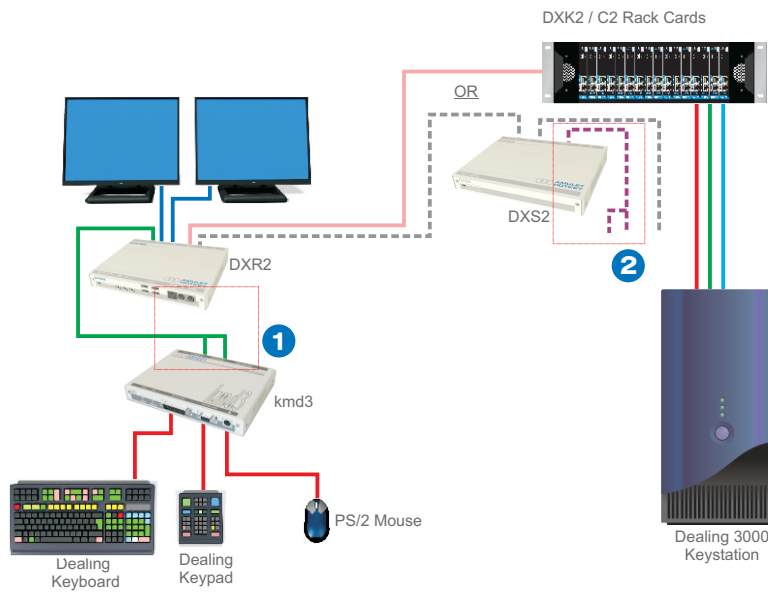

- 1 DXR2 to kmd3 1m Serial Splitter Cable (Amulet Hotkey PN: CL-DXDL-0002)
- 2 DXS2 to Dealing 3000 2m Serial Splitter Cable (Amulet Hotkey PN: CL-DXDL-0003)

Figure 2

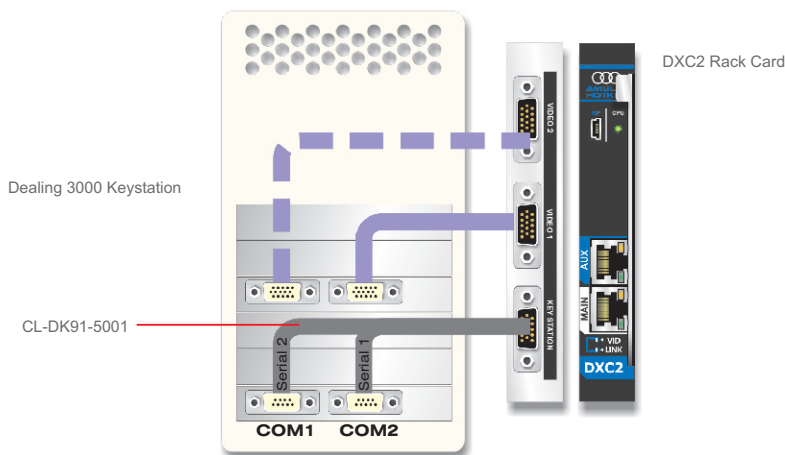

Information in this document is subject to change. No part of this document may be reproduced through any means including (but not limited to) electronic or mechanical, without express written permission from Amulet Hotkey Ltd. Amulet Hotkey Ltd may have patents, patent applications, trademarks or copyrights or other intellectual property rights covering subject matter in this document. Other product names and company names listed within this document may be trademarks of their respective owners. © Amulet Hotkey Ltd. All rights reserved.